

# Astronomy and culture in Istanbul

Rosa M. Ros

*NASE, International Astronomical Union*



# Santa Sofia

- Christian Church (532-1054)
- Orthodox Church (1054-1453)
- Mosque (1453-1931)
- Museum (1935-2020)
- Mosque (2020- up to date)

# Orientation of Santa Sofia

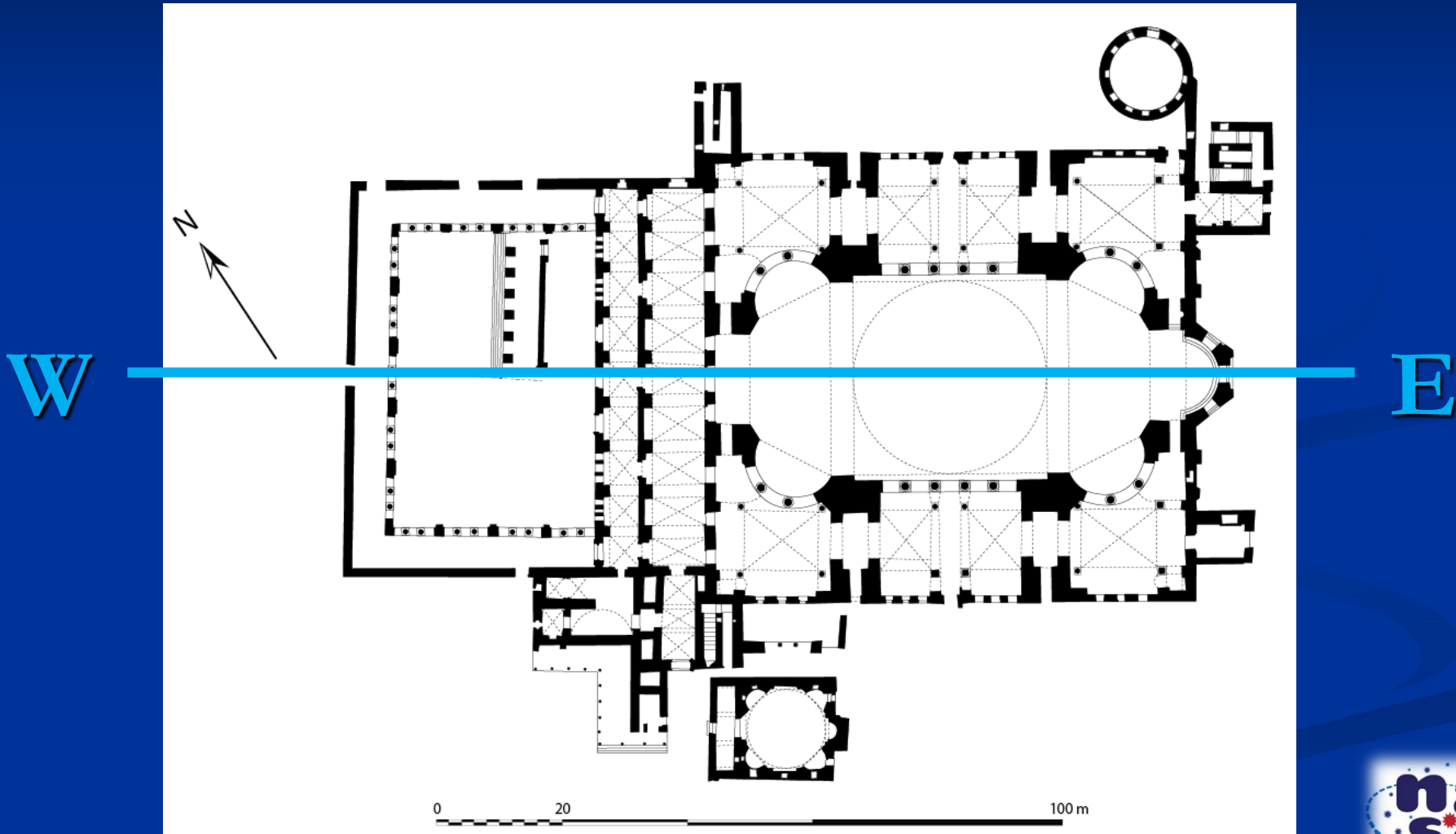

At the Council of Nicaea (325) it was determined that the apse of a church was to the East and the gateway to the West so that the priest would be facing East during the services.

At thus the priest and the participants would be directed towards the East, from where Christ, the Sun of Justice, will shine at the end of time

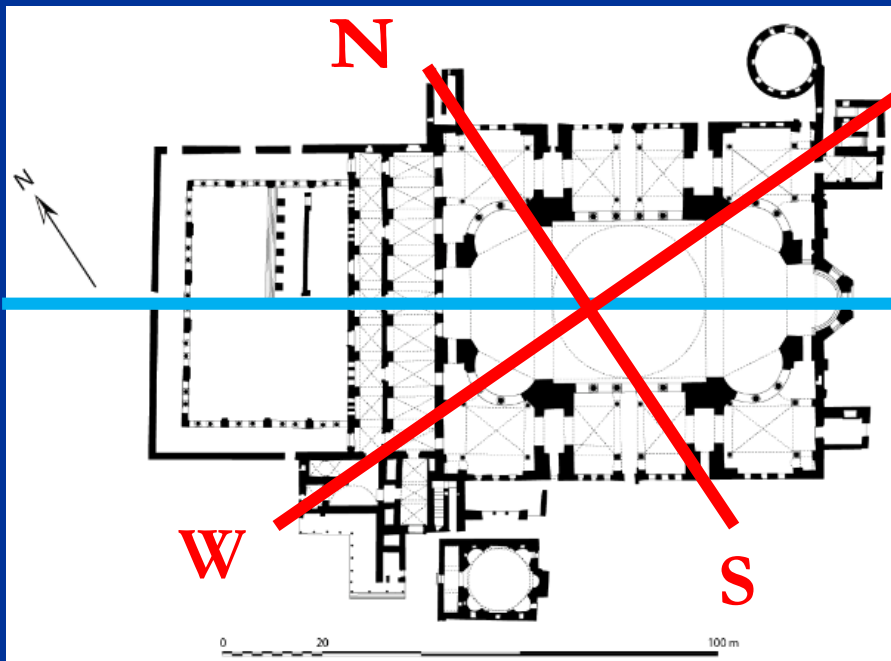

# Orientation of Santa Sofia “Church”

- Christian (532-1054)
- Orthodox (1054-1453)

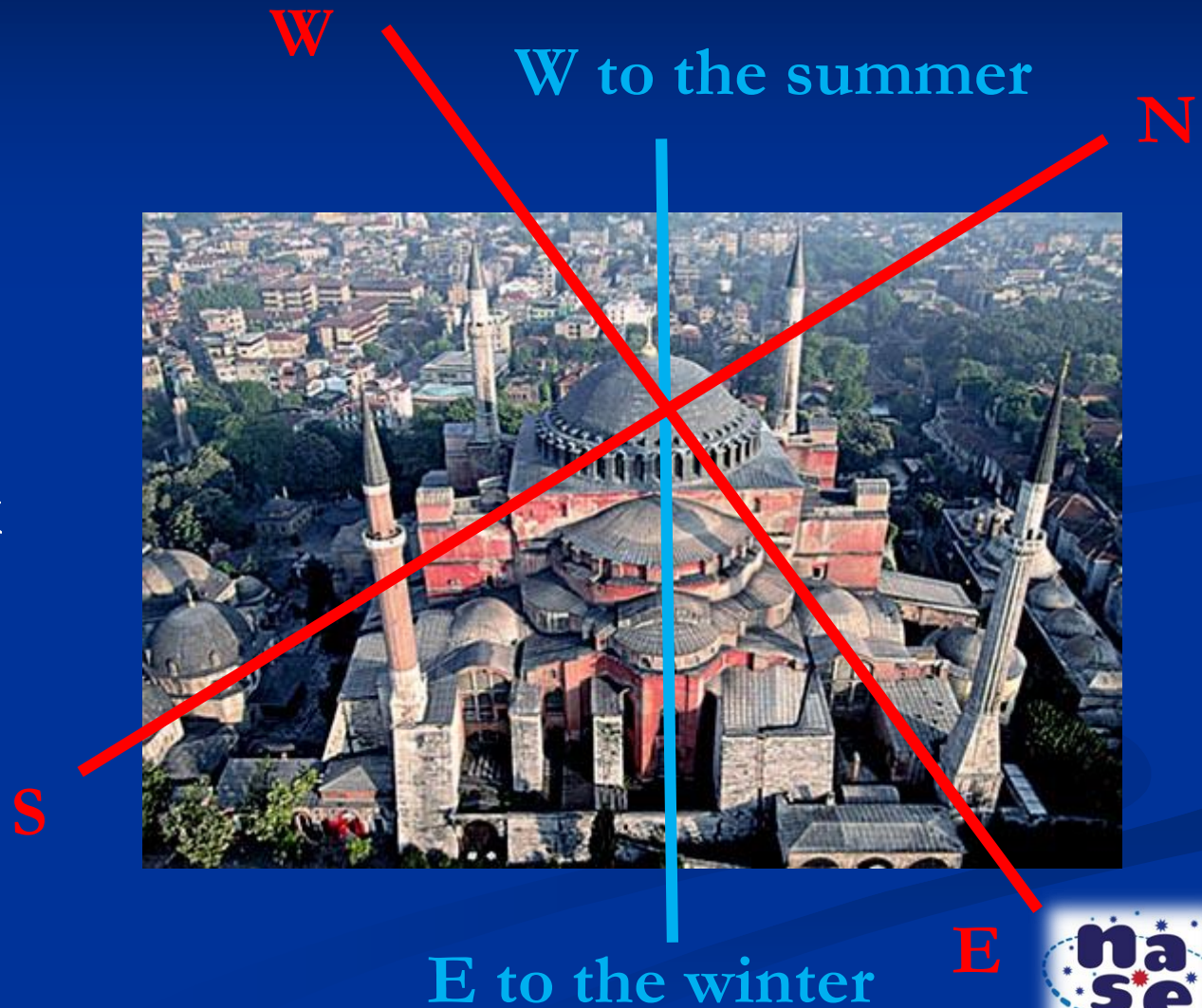

# Orientation of Santa Sofia “Mosque”

- Mosque (1453-1931)
- Mosque (2020- up to date)

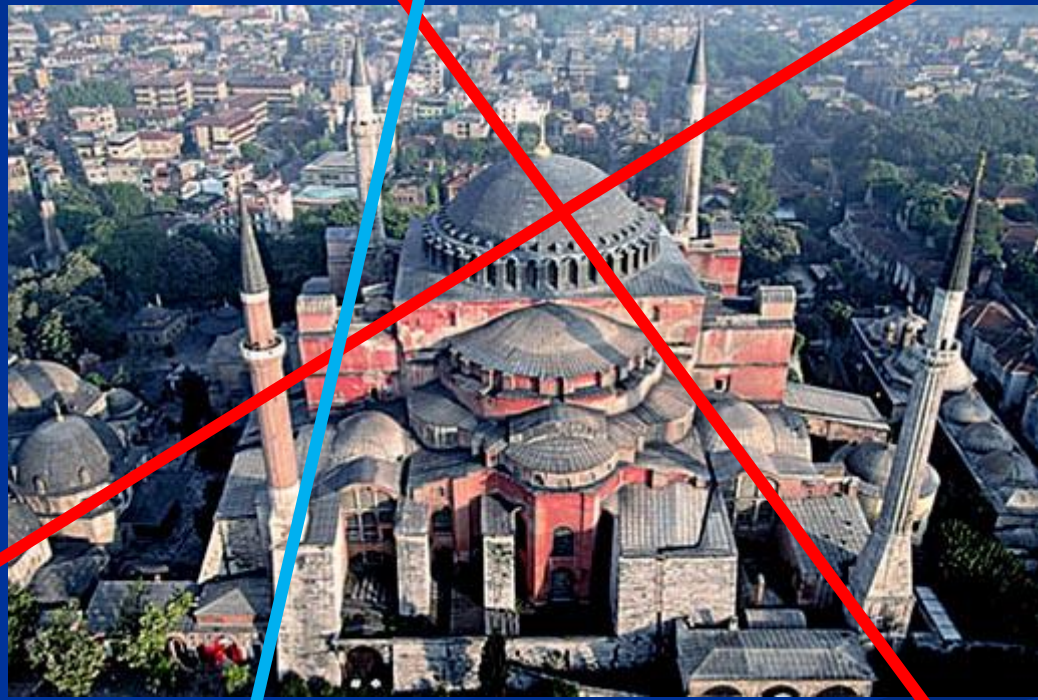

Qibla to the S



# Orientation of Santa Sofia “Mosque”

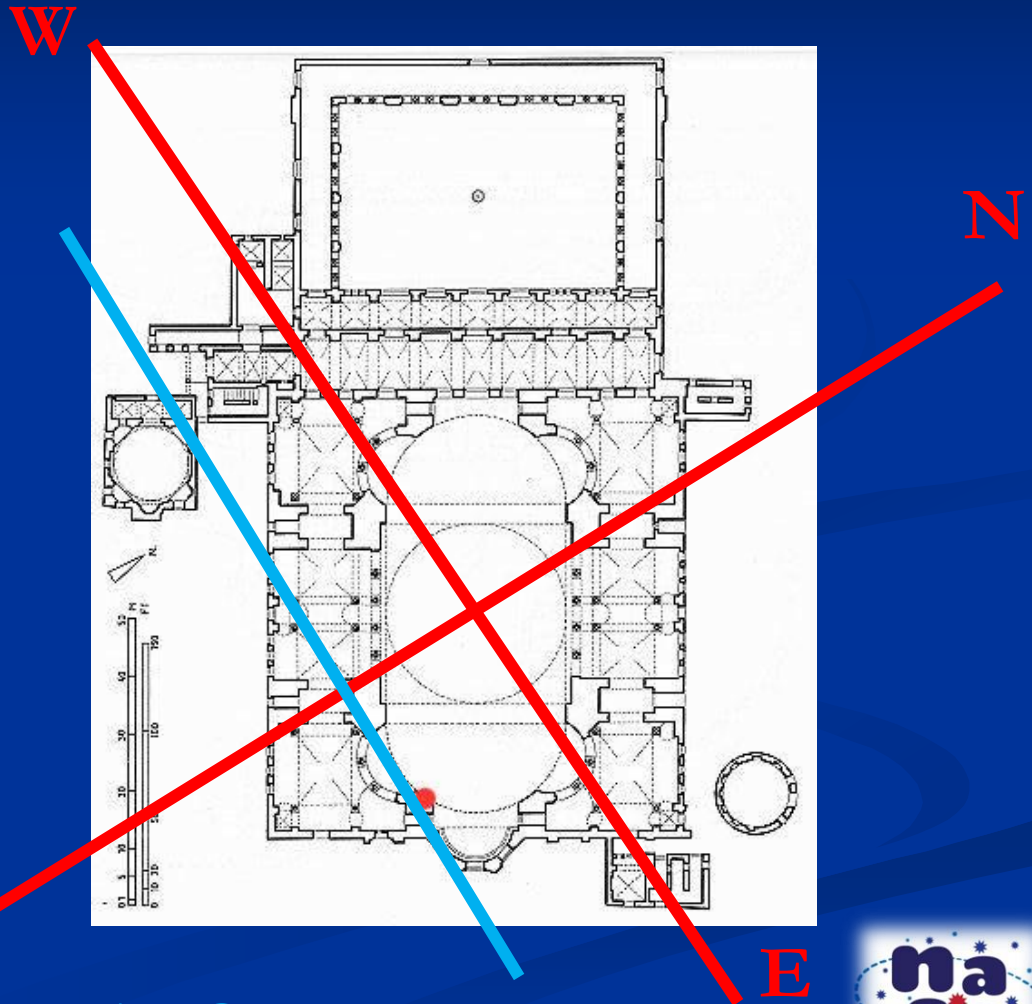

Qibla to the S



# Orientation of Blue Mosque

- Constructed by Ahmed I (1609 - 1617)  
Adapted to space

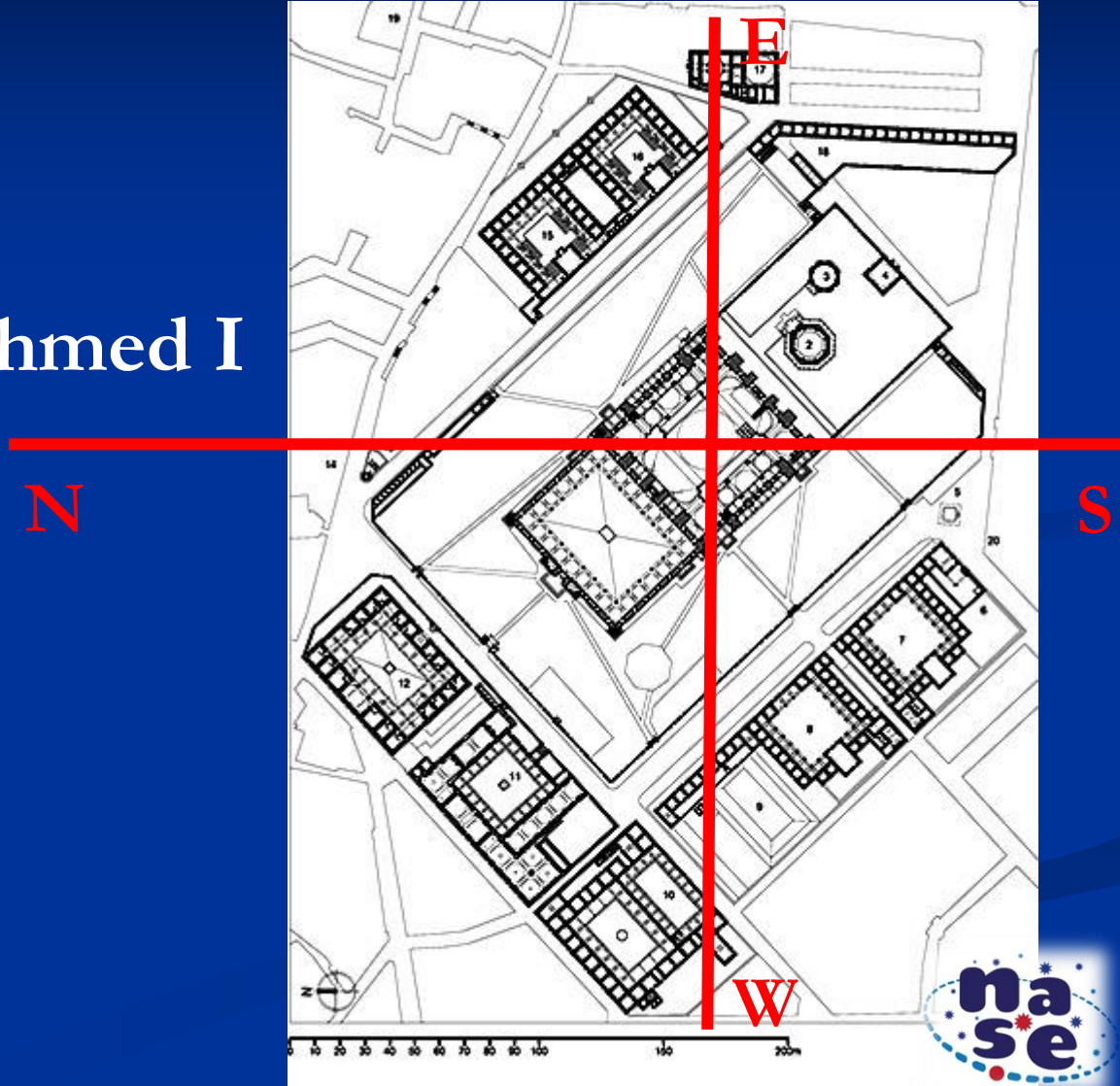

# Orientation of Blue Mosque

Kaaba to SE

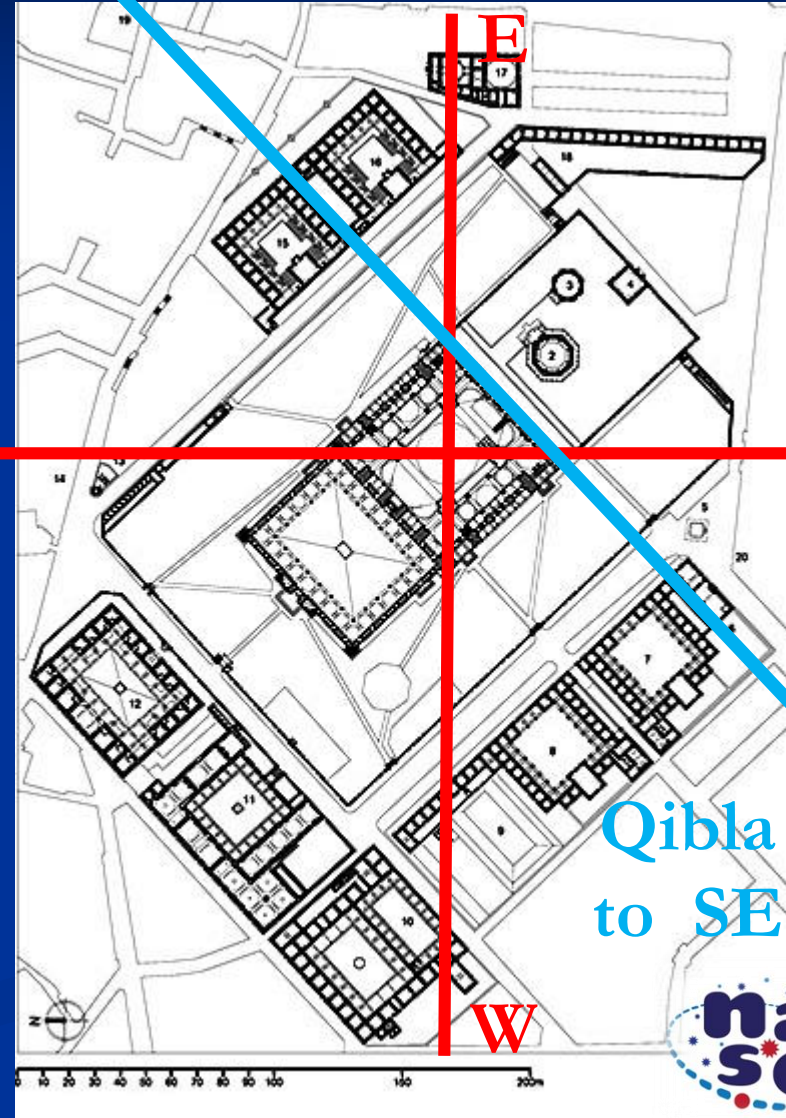
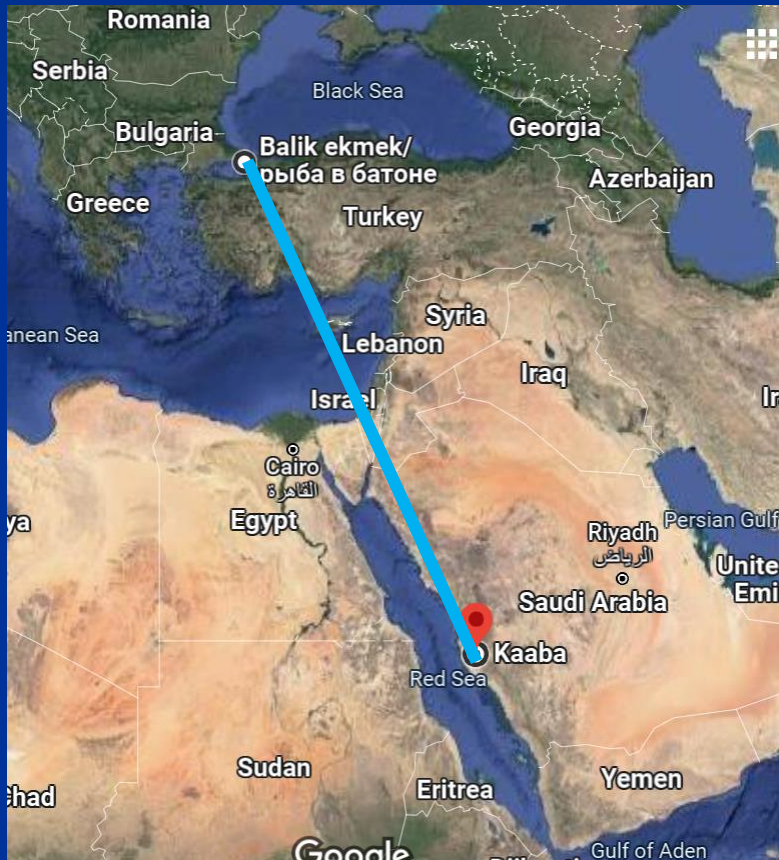

# Orientation of Blue Mosque

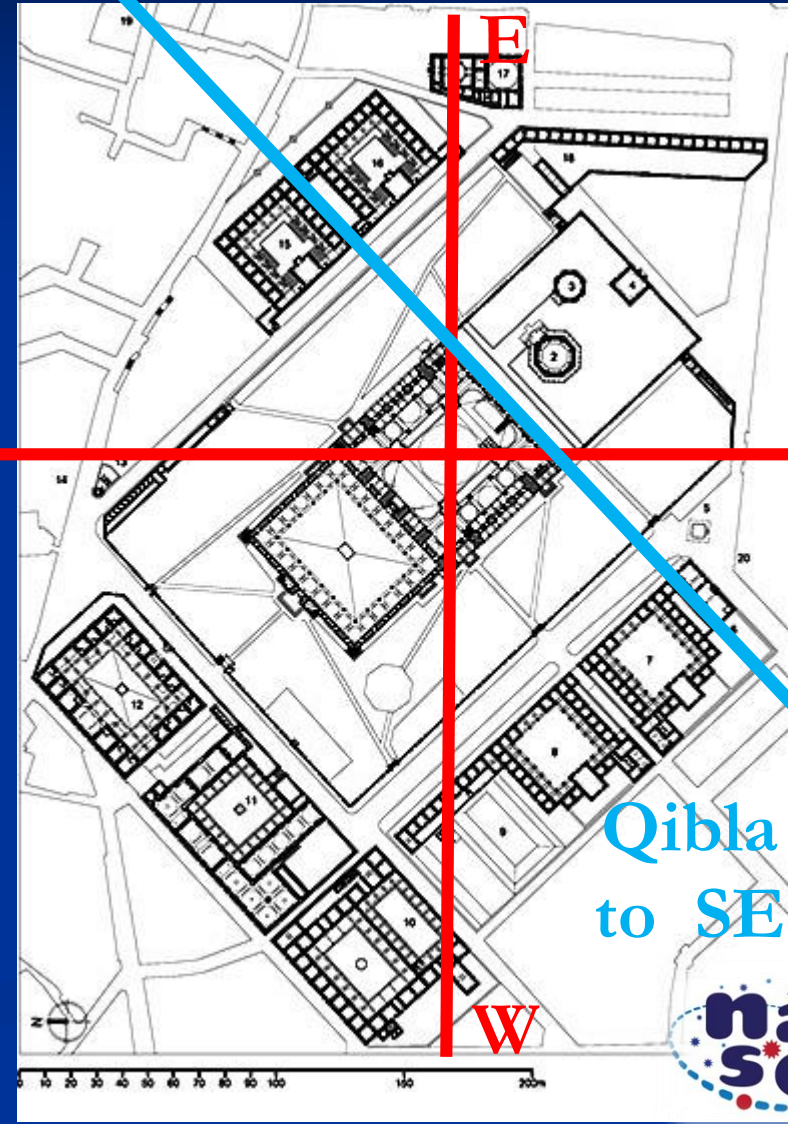

Qibla  
to SE



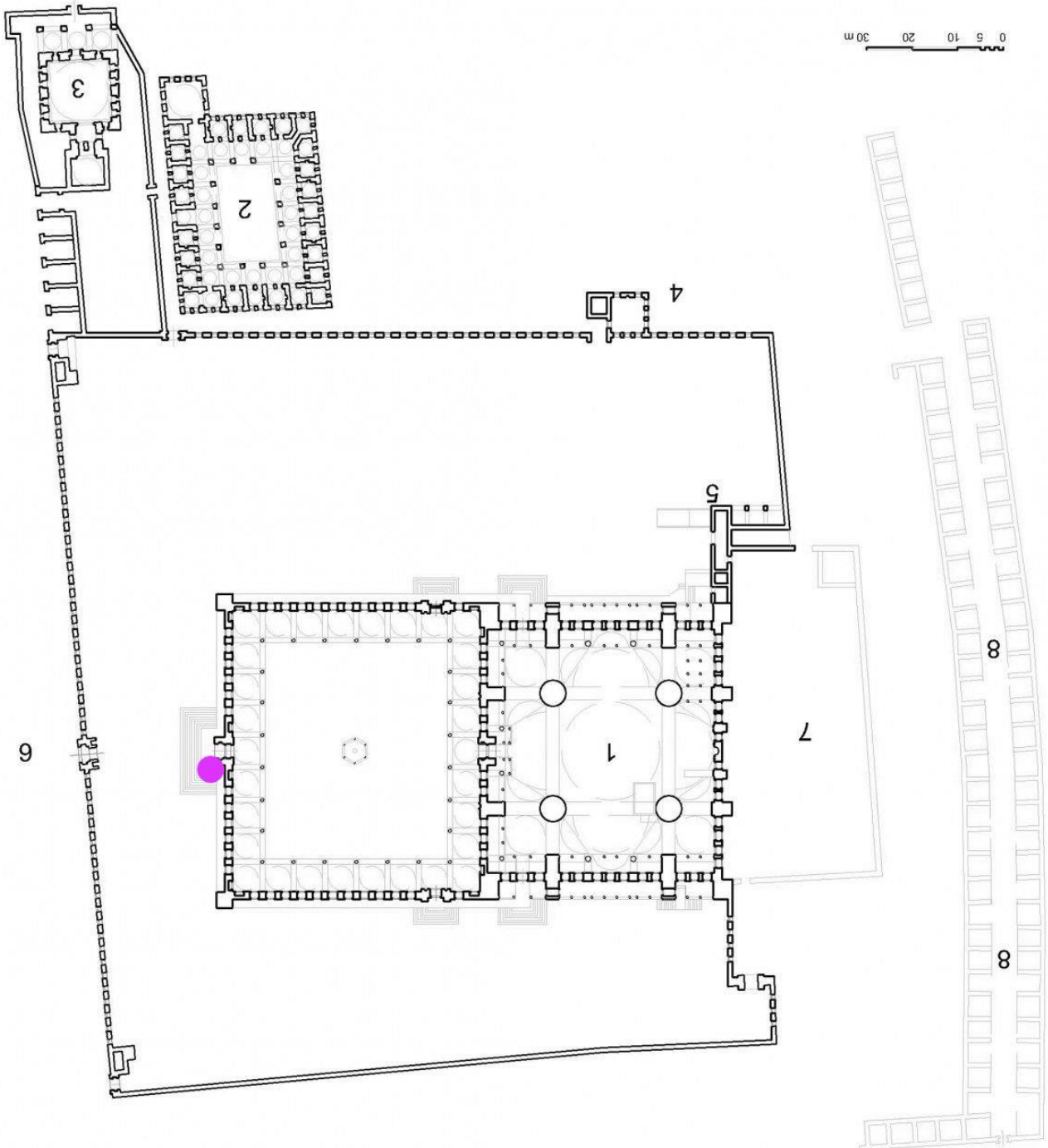

Thank you very much  
for your attention!

